

LE PETIT THEATRE

TECHNICAL OVERVIEW SPECS AND DRAWINGS

Le Petit Theatre du Vieux Carre
616 St. Peter St.
New Orleans, Louisiana 70116

March 26th, 2026

This document is intended to provide general technical information regarding Le Petit Theatre's building. Please refer to the accompanying documents for more details. Note that the drawings can be delivered in several formats including .skp, .dwg, and .vwx.

For questions and to discuss details please contact:

Bethany Lee, Production Manager
Email: blee@lepetittheatre.com
Direct: 225.802.4370

Seating Counts

Orchestra Fixed Seats – 205
Orchestra Removable Seats (ADA Accessible) – 4
Balcony Fixed Seats – 114
Total Seating Capacity - 323

Helpful Links:

[360 Walkthrough of LPT and Tableau](#)
[LPT Website - Rentals Page](#)
[LPT Rental Inquiry Form](#)

Power Distribution

The building has 120/240 single phase power. The building is equipped with (2) 60AMP, three phase Cam lock tie-ins. One is backstage behind the crossover wall, and the other is in our control booth in the balcony.

Stage & Scenic

Le Petit Theatre is a small proscenium theatre, built in 1922, with several renovations and modernizations since. As detailed in the attached drawings, the proscenium is 28'-10" wide. The total usable stage depth is about 31' (including the pit cover). The stage has very shallow wings left and right. There is a scenic wall about 3' from the upstage building wall that creates an effective cross over path. Our stock soft goods hang includes a dark red grand drape, a light blue synthetic silk like curtain, and three sets of black legs & borders. We do not have a full stage black.

LE PETIT THEATRE

TECHNICAL OVERVIEW SPECS AND DRAWINGS

Lighting

The theatre is equipped with a complete theatrical lighting package. Our theatre stays hung with a complete plot of Source Fours, Fresnels, and Pars, as well as (2) I-Qs and (11) Martin Mac Auras. Our house console is an ETC Ion. We can provide complete rep plot information. Our staff is available to assist with lighting in any way you need. We generally don't rearrange the rep plot for special events, we prefer instead to use our moving lights to take care of any special needs you have.

Sound

Our house sound system consists of (2) arrays of JBL VRX powered speakers for main L&R, (2) AudioTechnica front fill speakers, mounted on the front of the stage, (2) JBL hung speakers just upstage of the proscenium stage right and left and (2) JBL VRX subs that can be placed as needed. We have (6) additional wedges (various types) that can be placed as needed for use as monitors or for practical effects. The FOH Console is a SoundCraft VI3000. This generally lives at the back of the balcony in our built-in control booth. In some situations we may move the audio console to a purpose-built table in the back left corner of the orchestra. Installed and available for use in the theatre is also an Assisted Listening System through ListenTech. In order for this system to be used, the performers onstage must be wearing or using microphones. Patrons are welcome to use their phone to connect to the system or any of the following options paired with a receiver: headphones, earphones, or over ear piece.







Video

A 16' x 10' projection screen is installed and can be flown in just upstage of the grand drape. There is one 8k projector, an NEC NP-PA803U 3 Chip LCD, installed on the underside of the balcony. The native resolution is 1920x1200, which works well on our 16:10 screen. We can project 16:9 video with small black bars top & bottom. The installed playback system is a MacBook Pro, running QLab 5. Video is sent as HDMI via SDI converters through an SDI patch bay installed in the lighting booth. You are welcome to bring your own play back equipment as well, provided it outputs HDMI. We are not able to accommodate DCP at this time, but can recommend vendors who can.

LE PETIT THEATRE

Seating Tiers

effective beginning with 2025-26 Season

-  Premier Seats (62)
-  Tier 1 Seats (130)
-  Tier 2 Seats (85)
-  Tier 3 Seats (42)
-  ADA Seats (4)
-  Possibly Partially Obstructed Seats (determined per show)

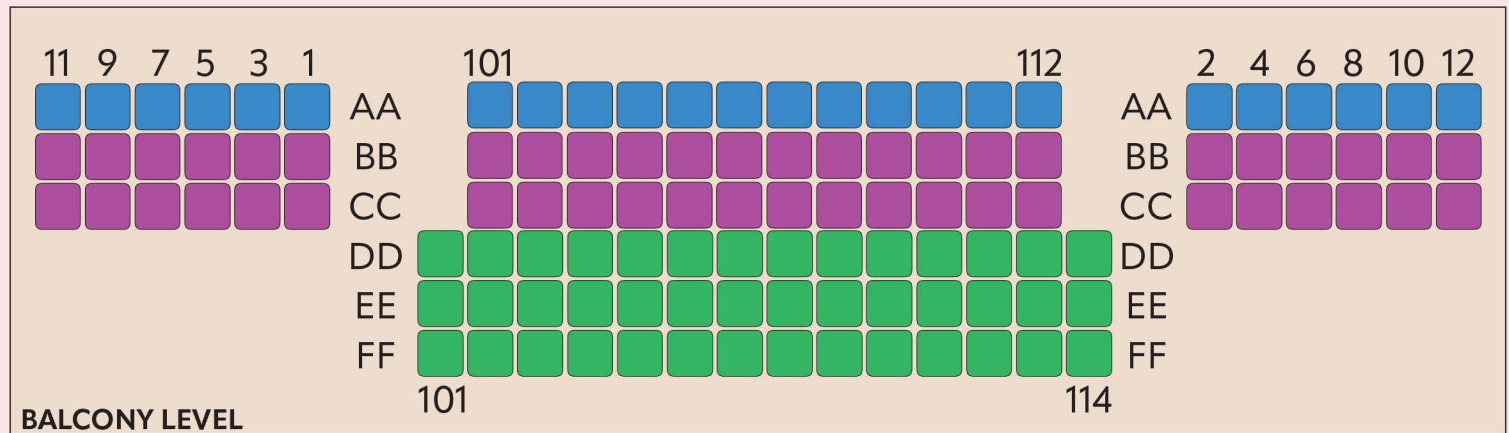
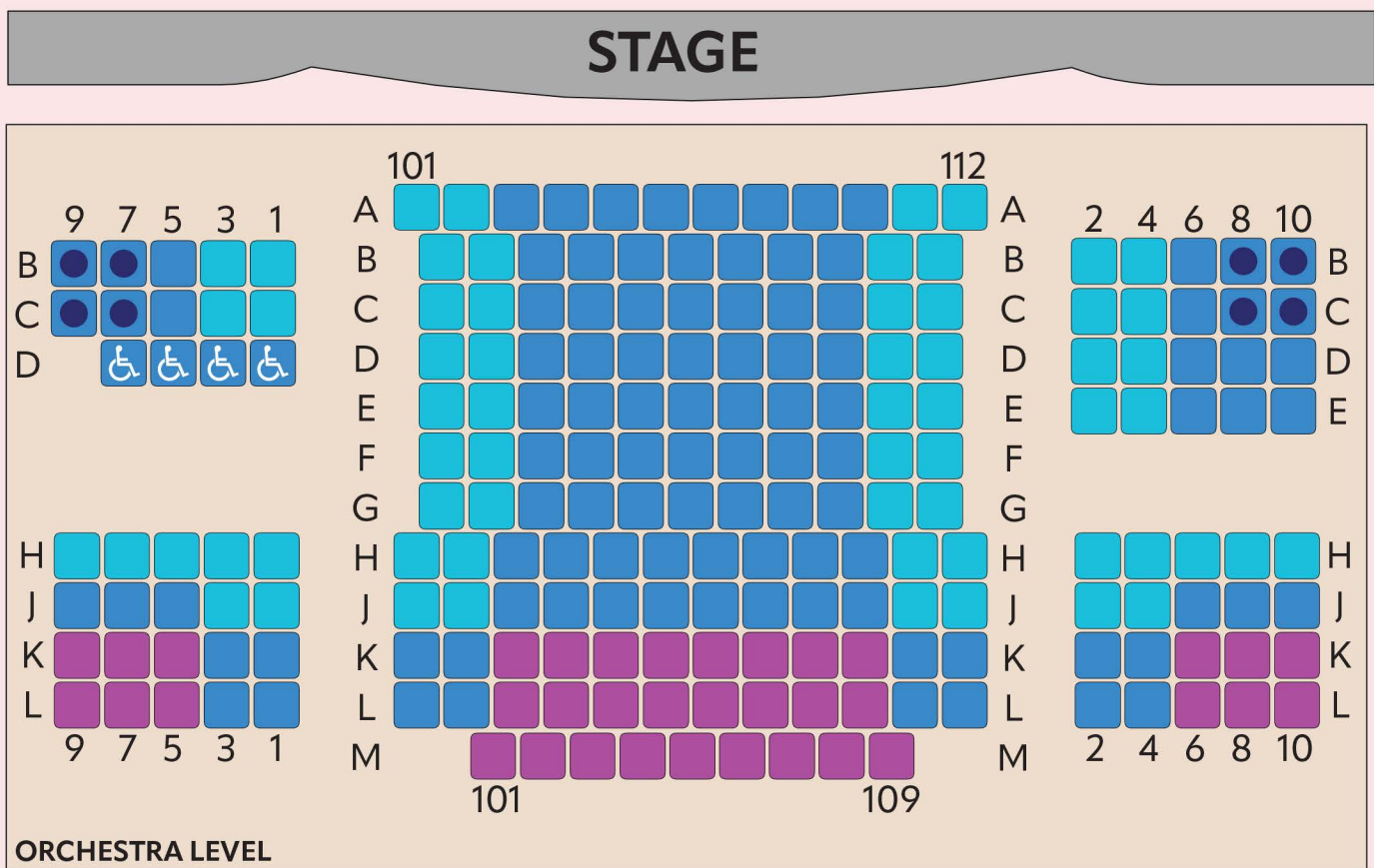

Orchestra - 209 Seats
 Balcony - 114 Seats
Total - 323 Seats

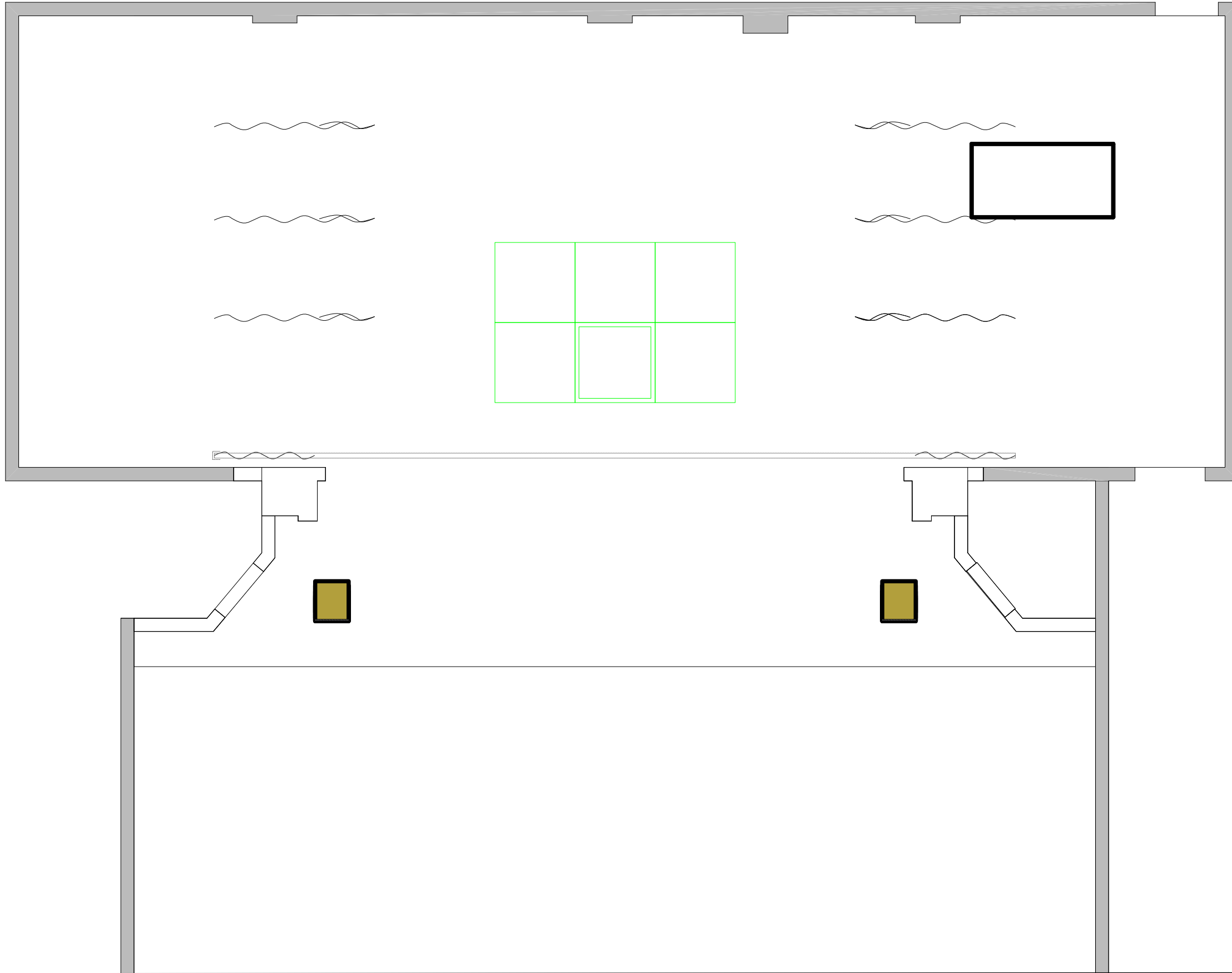

Revision Date

9/24/16

Load-In Date

N/A

Project

LPT - Space Drawings

Updated By

J Lanius

Sheet Title

GP - Clear Stage



DISCLAIMER: LE PETIT THEATRE MAKES NO REPRESENTATION OR WARRANTIES, EXPRESS OR IMPLIED, WITH RESPECT TO THE USE OF THE DRAWING PROVIDED HEREIN, REGARDLESS OF ITS FORMAT OR THE MEANS OF ITS TRANSMISSION. THERE IS NO GUARANTEE OR REPRESENTATION TO THE USER AS TO THE ACCURACY, CURRENCY, SUITABILITY, OR RELIABILITY OF THIS DRAWING FOR ANY PURPOSE. THIS DRAWING AND INFORMATION CONTAINED HEREIN IS FOR GENERAL PRESENTATION PURPOSES ONLY. THE DRAWING IS NOT INTENDED FOR USE ON ENGINEERING DESIGN PLANS. THIS DRAWING AND THE INFORMATION CONTAINED THEREIN IS THE CONFIDENTIAL, PROPRIETARY INFORMATION OF LE PETIT THEATRE AND MAY NOT BE USED OR REPRODUCED WITHOUT APPROVAL OF LE PETIT THEATRE. COPYRIGHT LE PETIT THEATRE 2016. ALL RIGHTS RESERVED.

Upstage Faux Brick wall/Flat Wall
Creates Crossover

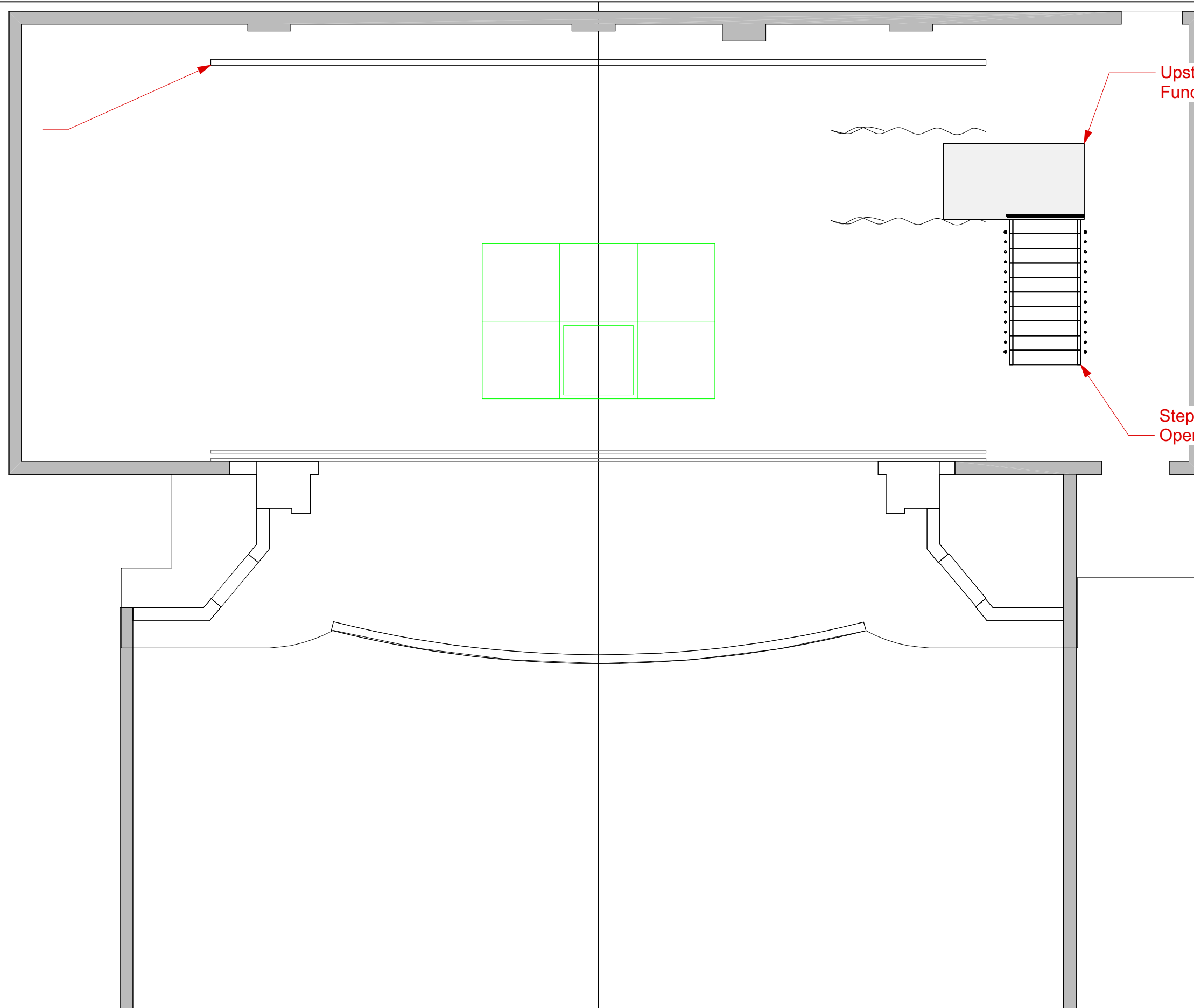

Upstage Cover installed.
Functions as floor.

Steps to Orchestra pit.
Open hole, with rails.

Revision Date

9/24/16

Load-In Date

N/A

Project

LPT - Space Drawings

Updated By

J Lanius

Sheet Title

GP - Rep Soft Goods Hang



DISCLAIMER: LE PETIT THEATRE MAKES NO REPRESENTATION OR WARRANTIES, EXPRESS OR IMPLIED, WITH RESPECT TO THE USE OF THE DRAWING PROVIDED HEREIN, REGARDLESS OF ITS FORMAT OR THE MEANS OF ITS TRANSMISSION. THERE IS NO GUARANTEE OR REPRESENTATION TO THE USER AS TO THE ACCURACY, CURRENCY, SUITABILITY, OR RELIABILITY OF THIS DRAWING FOR ANY PURPOSE. THIS DRAWING AND INFORMATION CONTAINED HEREIN IS FOR GENERAL PRESENTATION PURPOSES ONLY. THE DRAWING IS NOT INTENDED FOR USE ON ENGINEERING DESIGN PLANS. THIS DRAWING AND THE INFORMATION CONTAINED THEREIN IS THE CONFIDENTIAL, PROPRIETARY INFORMATION OF LE PETIT THEATRE AND MAY NOT BE USED OR REPRODUCED WITHOUT APPROVAL OF LE PETIT THEATRE. COPYRIGHT LE PETIT THEATRE 2016. ALL RIGHTS RESERVED.

Page

2

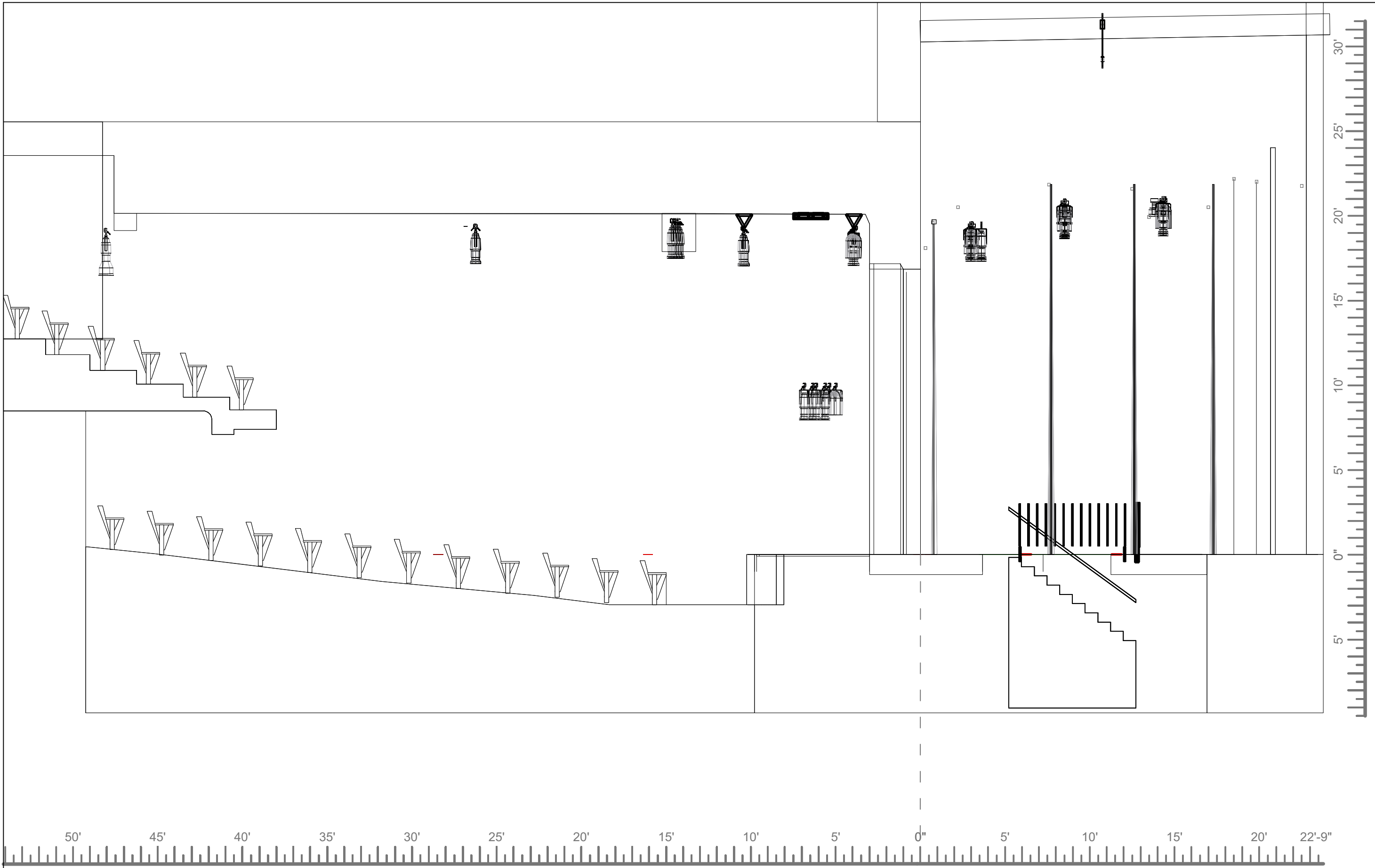

Revision Date
 9/24/16
 Load-In Date
 N/A

Project
 LPT - Space Drawings

Updated By
 J Lanius
 Sheet Title
 Section - With Softgoods



DISCLAIMER: LE PETIT THEATRE MAKES NO REPRESENTATION OR WARRANTIES, EXPRESS OR IMPLIED, WITH RESPECT TO THE USE OF THE DRAWING PROVIDED HEREIN, REGARDLESS OF ITS FORMAT OR THE MEANS OF ITS TRANSMISSION. THERE IS NO GUARANTEE OR REPRESENTATION TO THE USER AS TO THE ACCURACY, CURRENCY, SUITABILITY, OR RELIABILITY OF THIS DRAWING FOR ANY PURPOSE. THIS DRAWING AND INFORMATION CONTAINED HEREIN IS FOR GENERAL PRESENTATION PURPOSES ONLY. THE DRAWING IS NOT INTENDED FOR USE ON ENGINEERING DESIGN PLANS. THIS DRAWING AND THE INFORMATION CONTAINED THEREIN IS THE CONFIDENTIAL, PROPRIETARY INFORMATION OF LE PETIT THEATRE AND MAY NOT BE USED OR REPRODUCED WITHOUT APPROVAL OF LE PETIT THEATRE. COPYRIGHT LE PETIT THEATRE 2016. ALL RIGHTS RESERVED.

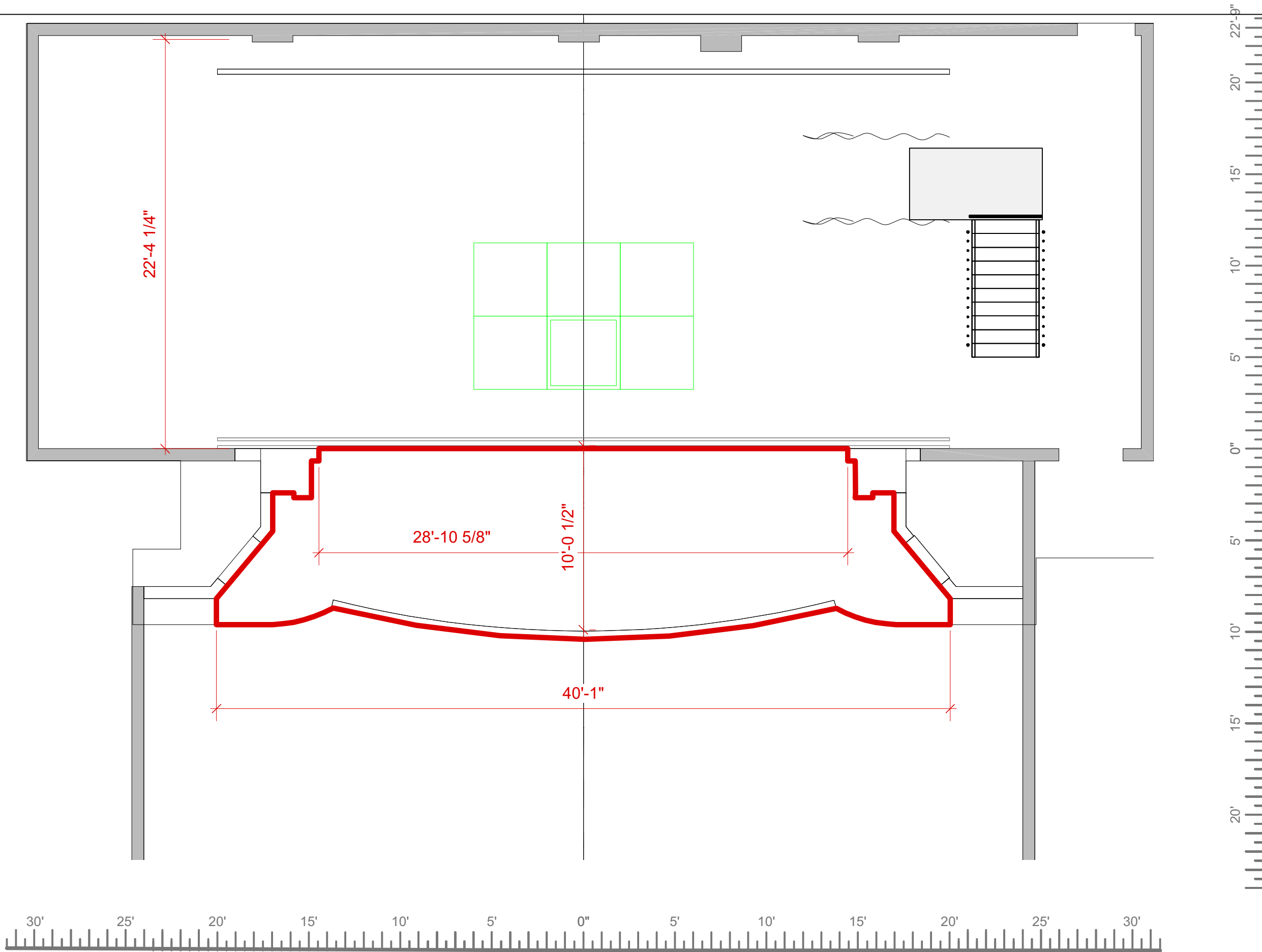

DISCLAIMER: LE PETIT THEATRE MAKES NO REPRESENTATION OR WARRANTIES, EXPRESS OR IMPLIED, WITH RESPECT TO THE USE OF THE DRAWING PROVIDED HEREIN, REGARDLESS OF ITS FORMAT OR THE MEANS OF ITS TRANSMISSION. THERE IS NO GUARANTEE OR REPRESENTATION TO THE USER AS TO THE ACCURACY, CURRENCY, SUITABILITY, OR RELIABILITY OF THIS DRAWING FOR ANY PURPOSE. THIS DRAWING AND INFORMATION CONTAINED HEREIN IS FOR GENERAL PRESENTATION PURPOSES ONLY. THE DRAWING IS NOT INTENDED FOR USE ON ENGINEERING DESIGN PLANS. THIS DRAWING AND THE INFORMATION CONTAINED THEREIN IS THE CONFIDENTIAL, PROPRIETARY INFORMATION OF LE PETIT THEATRE AND MAY NOT BE USED OR REPRODUCED WITHOUT APPROVAL OF LE PETIT THEATRE. COPYRIGHT LE PETIT THEATRE 2016. ALL RIGHTS RESERVED.

Revision Date
9/24/16
Load-In Date
N/A

Project
LPT - Space Drawings

Updated By
J Lanius
Sheet Title
GP - With Dims



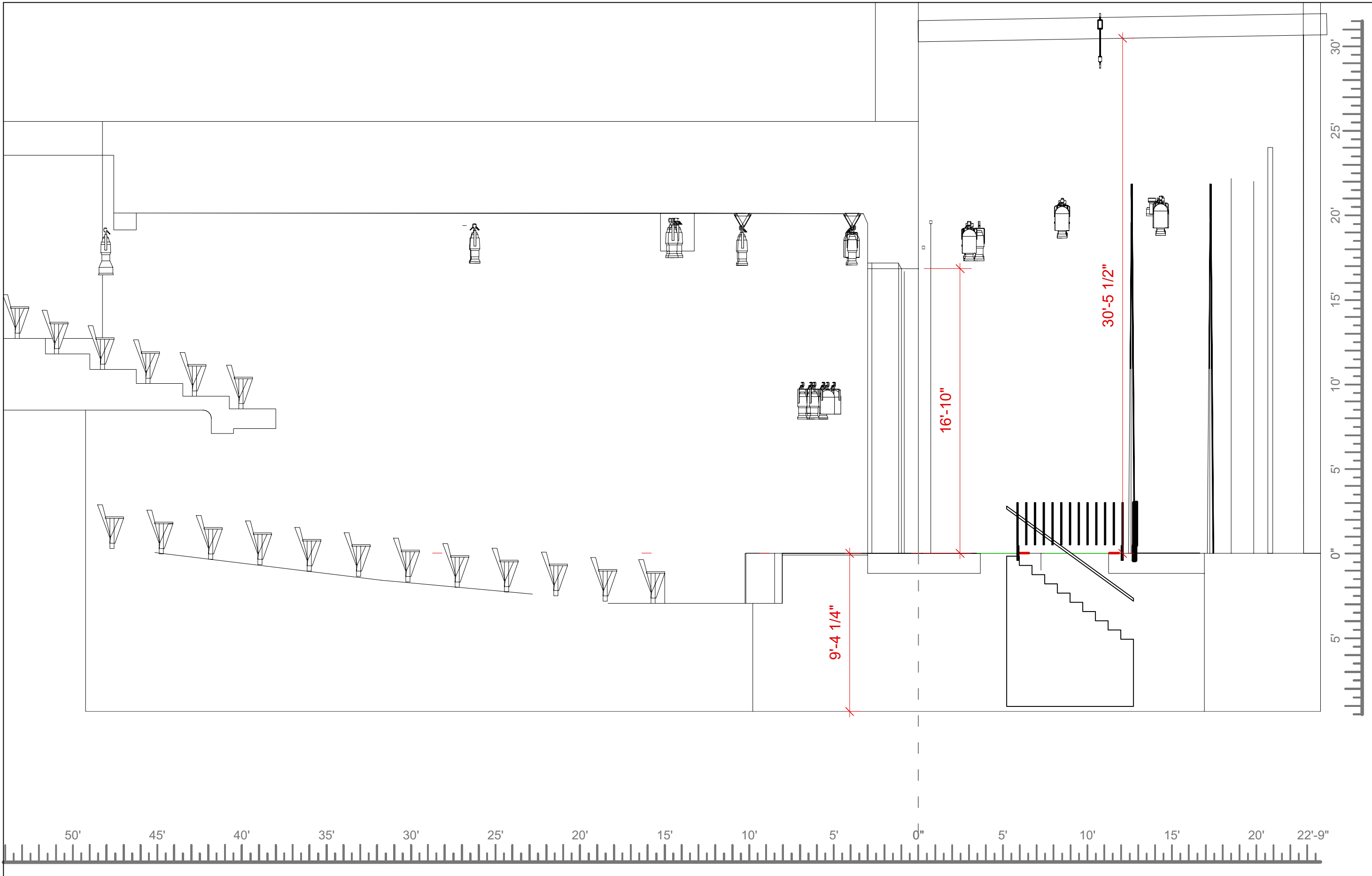

DISCLAIMER: LE PETIT THEATRE MAKES NO REPRESENTATION OR WARRANTIES, EXPRESS OR IMPLIED, WITH RESPECT TO THE USE OF THE DRAWING PROVIDED HEREIN, REGARDLESS OF ITS FORMAT OR THE MEANS OF ITS TRANSMISSION. THERE IS NO GUARANTEE OR REPRESENTATION TO THE USER AS TO THE ACCURACY, CURRENCY, SUITABILITY, OR RELIABILITY OF THIS DRAWING FOR ANY PURPOSE. THIS DRAWING AND INFORMATION CONTAINED HEREIN IS FOR GENERAL PRESENTATION PURPOSES ONLY. THE DRAWING IS NOT INTENDED FOR USE ON ENGINEERING DESIGN PLANS. THIS DRAWING AND THE INFORMATION CONTAINED THEREIN IS THE CONFIDENTIAL, PROPRIETARY INFORMATION OF LE PETIT THEATRE AND MAY NOT BE USED OR REPRODUCED WITHOUT APPROVAL OF LE PETIT THEATRE. COPYRIGHT LE PETIT THEATRE 2016. ALL RIGHTS RESERVED.

Revision Date
9/24/16
Load-In Date
N/A

Project
LPT - Space Drawings

Updated By
J Lanius
Sheet Title
Section - With Dims



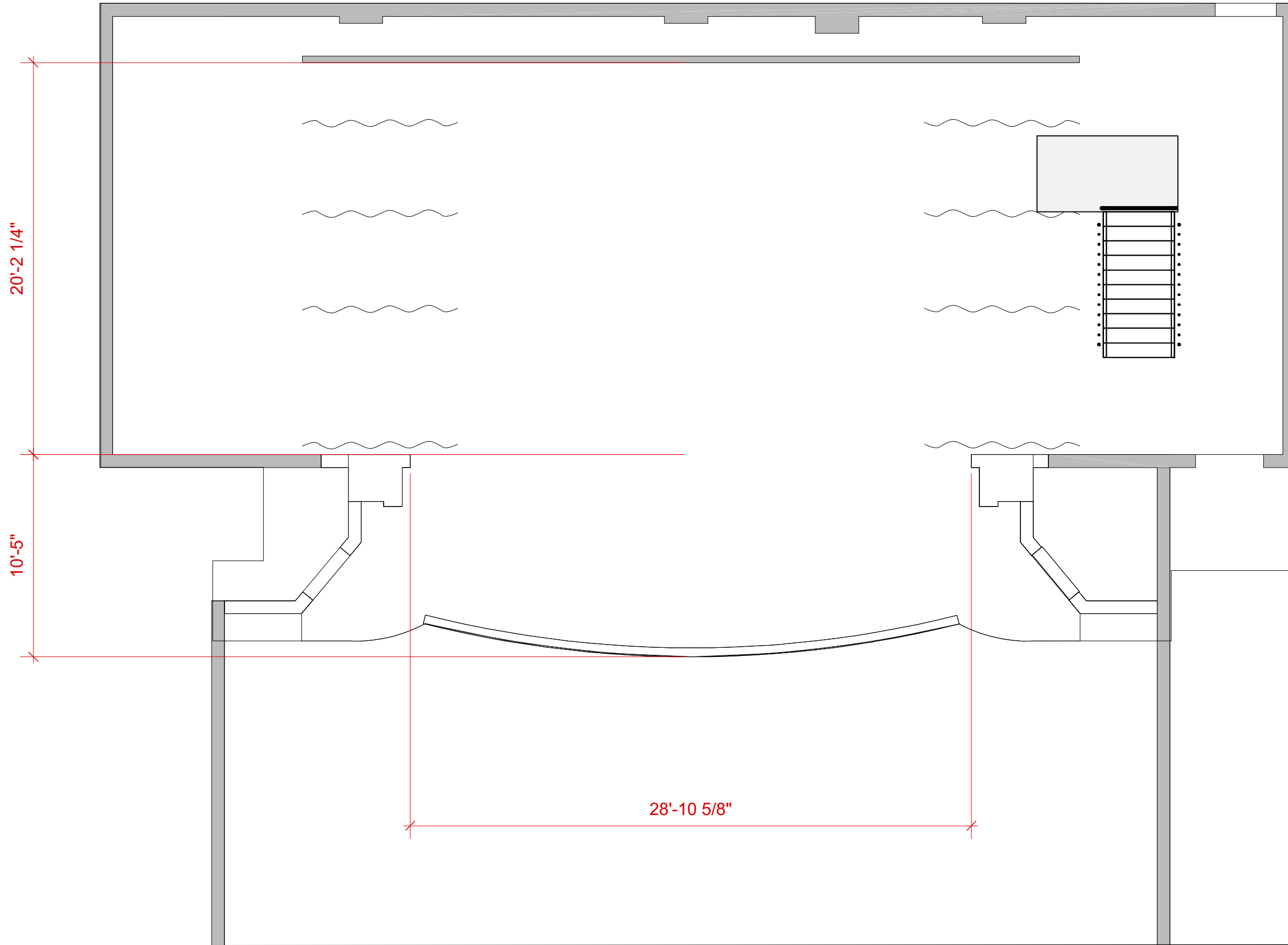

DISCLAIMER: LE PETIT THEATRE MAKES NO REPRESENTATION OR WARRANTIES, EXPRESS OR IMPLIED, WITH RESPECT TO THE USE OF THE DRAWING PROVIDED HEREIN, REGARDLESS OF ITS FORMAT OR THE MEANS OF ITS TRANSMISSION. THERE IS NO GUARANTEE OR REPRESENTATION TO THE USER AS TO THE ACCURACY, CURRENCY, SUITABILITY, OR RELIABILITY OF THIS DRAWING FOR ANY PURPOSE. THIS DRAWING AND INFORMATION CONTAINED HEREIN IS FOR GENERAL PRESENTATION PURPOSES ONLY. THE DRAWING IS NOT INTENDED FOR USE ON ENGINEERING DESIGN PLANS. THIS DRAWING AND THE INFORMATION CONTAINED THEREIN IS THE CONFIDENTIAL, PROPRIETARY INFORMATION OF LE PETIT THEATRE AND MAY NOT BE USED OR REPRODUCED WITHOUT APPROVAL OF LE PETIT THEATRE. COPYRIGHT LE PETIT THEATRE 2016. ALL RIGHTS RESERVED.

Revision Date
9/24/16
Load-In Date
N/A

Project
LPT - Space Drawings

Updated By
J Lanius
Sheet Title
GP - Clear Stage



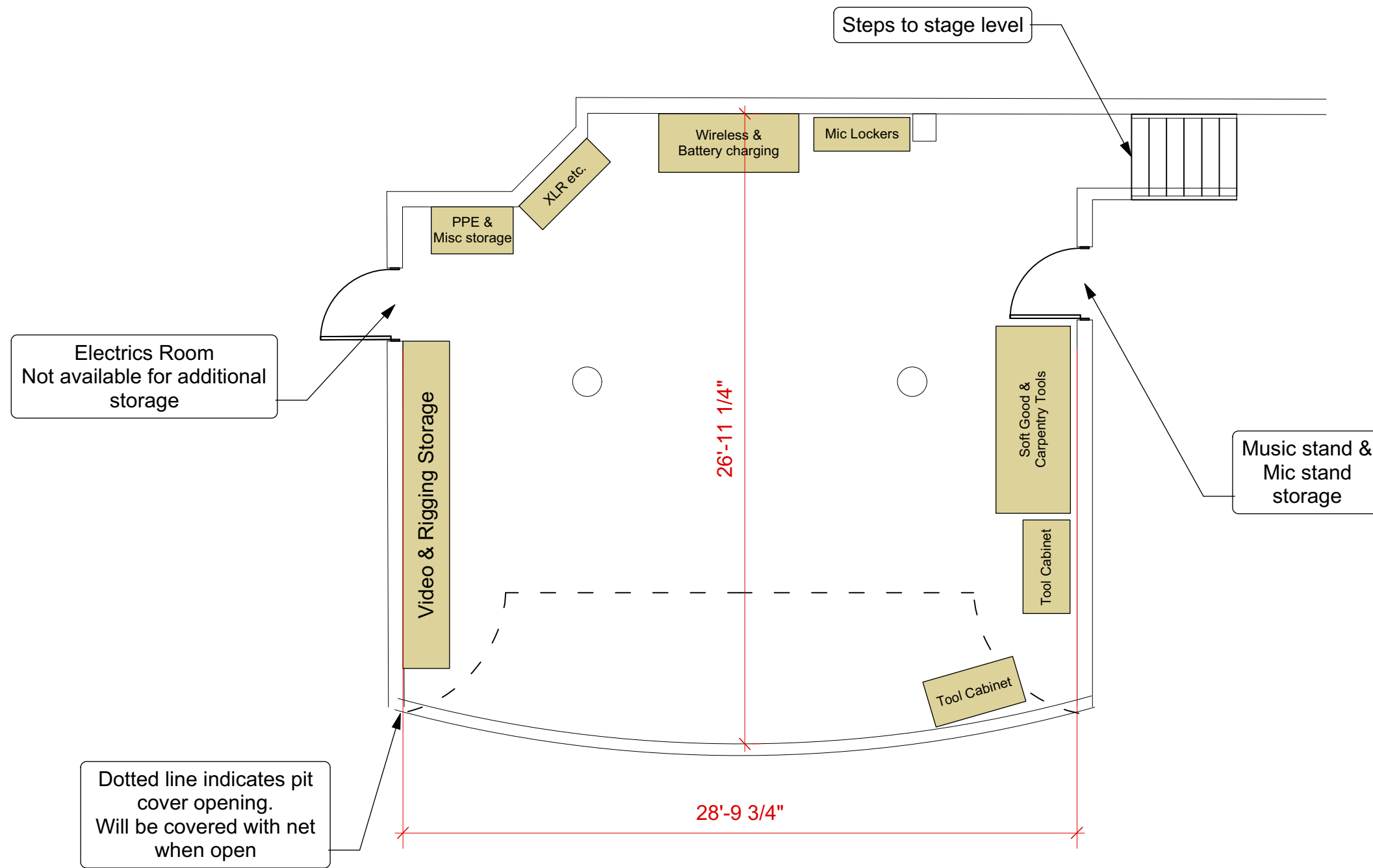

Dotted line indicates pit cover opening. Will be covered with net when open

1 Orchestra Pit Schematic Layout
Scale: 3/16" = 1'-0"

Revision Date
11/9/17
Load-In Date
N/A

Project
LPT - Space Drawings

Updated By
J Lanius
Sheet Title
GP - Orchestra Pit Layout



Le Petit Theatre Du Vieux Carre Building Plan, 1st Floor

Le Petit Theatre Spaces

Tableau Restaurant Spaces

CHARTRES STREET

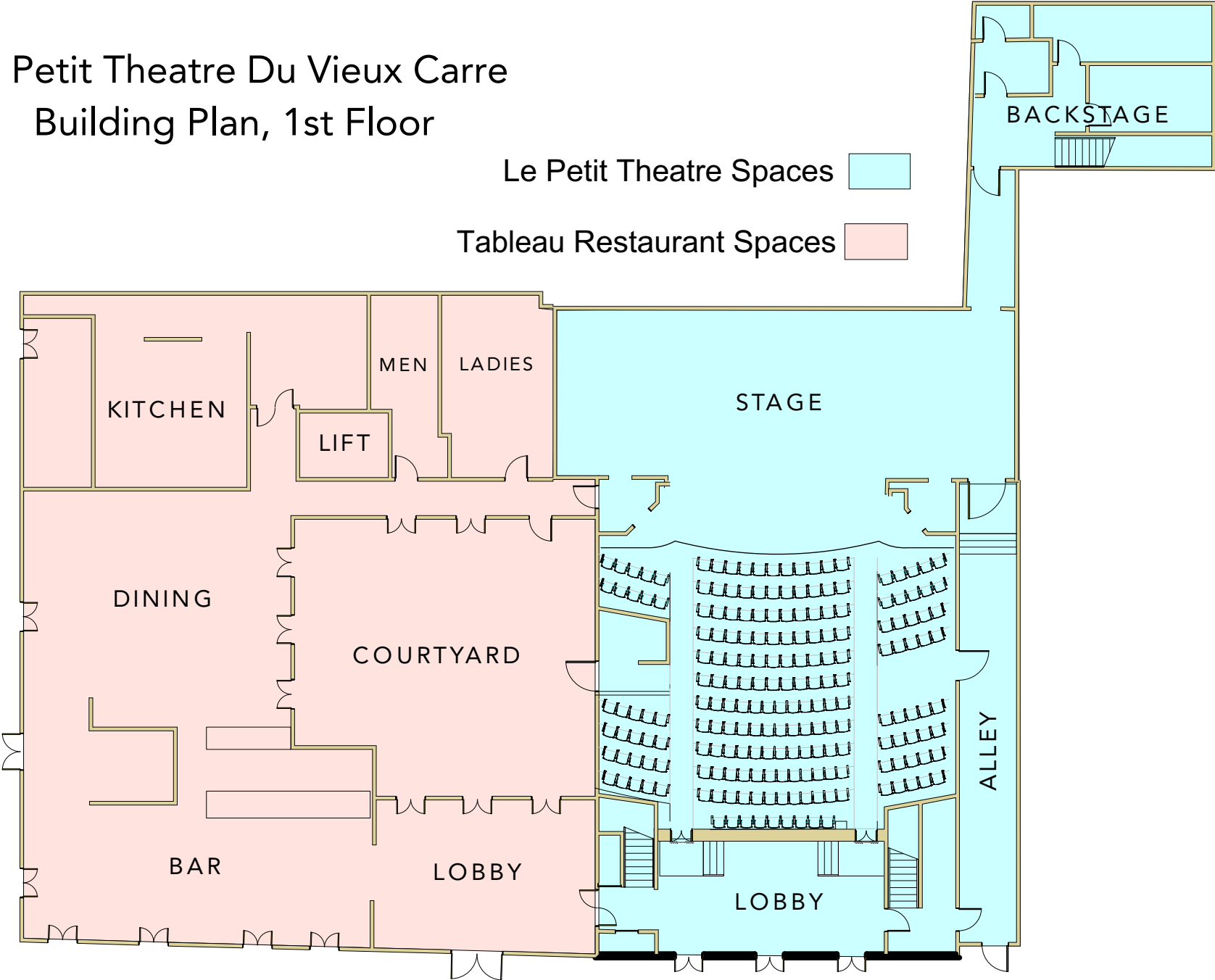

SAINT PETER STREET